

HEEL LETTERING: ROUND NOSE STYLE, RAISED .012"

KNURLING: (1) ROW OF BPK-160 KNURL TO APPEAR ON BEARING SURFACE

BOTTOM LETTERING: ROUND NOSE STYLE

TRADEMARK: No. 0

70-2035 A  
C-97606

THIS DOCUMENT IS CONFIDENTIAL AND CONTAINS PROPRIETARY INFORMATION AND INTELLECTUAL PROPERTY INCLUDING, BUT NOT LIMITED TO, TRADEMARKS, COPYRIGHTS, TRADE SECRETS, AND KNOW-HOW OF ANCHOR GLASS. THIS INFORMATION MAY NOT BE USED, DISCLOSED OR REPRODUCED, IN WHOLE OR IN PART, WITHOUT THE PRIOR WRITTEN CONSENT OF ANCHOR GLASS. TITLE IN AND TO THIS DOCUMENT AND ALL INFORMATION CONTAINED HEREIN REMAINS AT ALL TIMES IN ANCHOR GLASS.

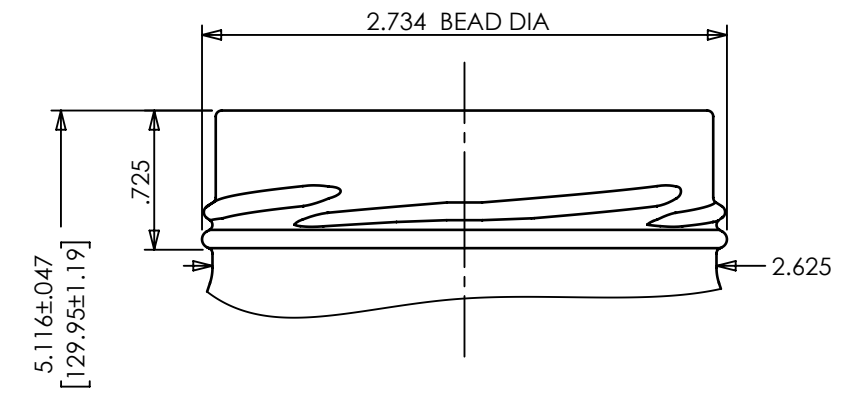
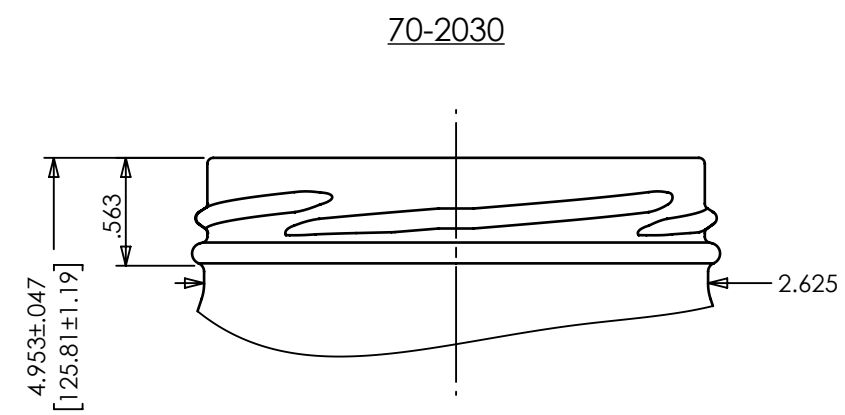
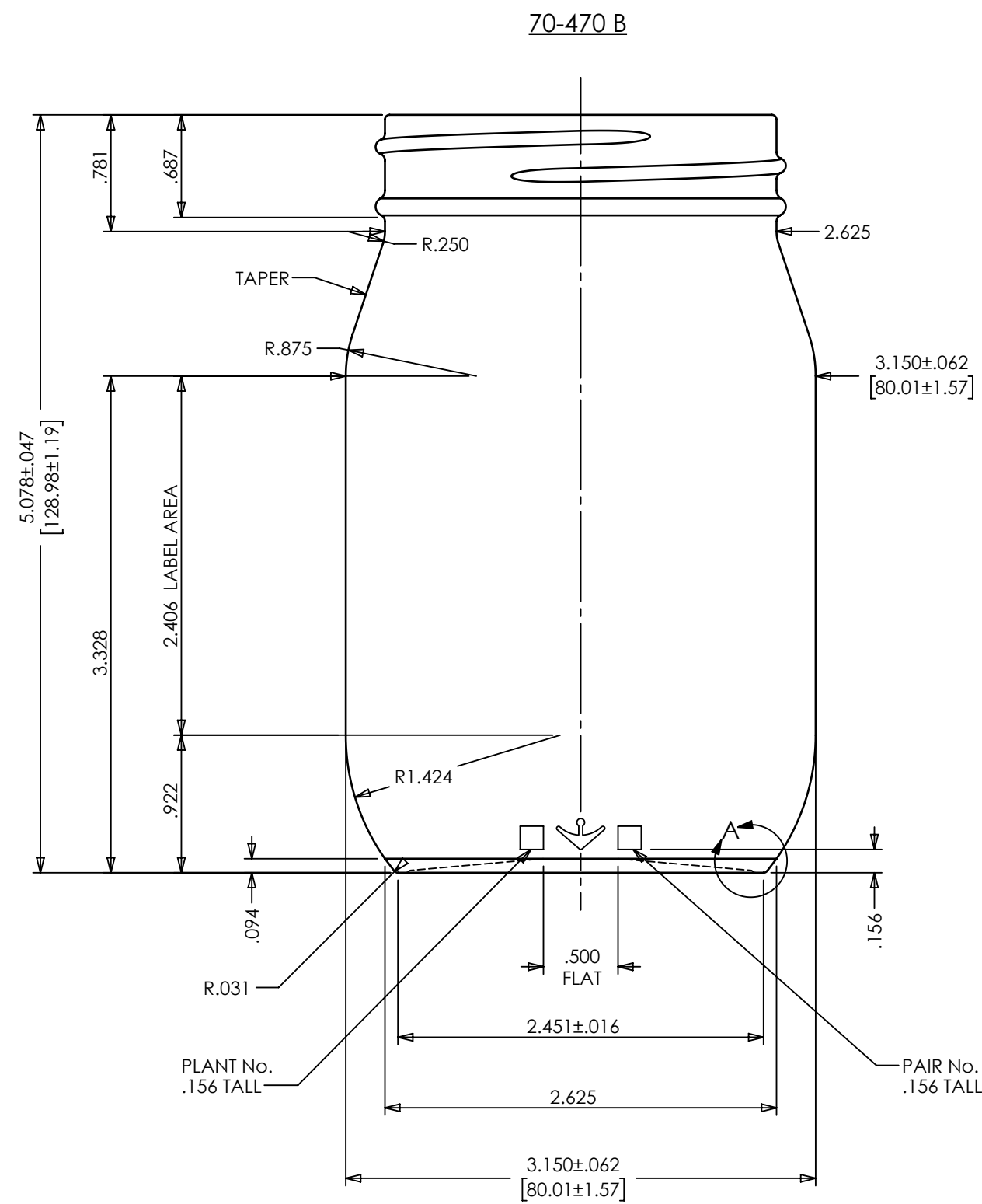

NOTE:  
IF EMHART CAVITY IDENTIFICATION DOT CODE IS USED, THEY WILL APPEAR ONCE, CENTERED AS SHOWN. USE 10 DOT CODE ONLY.

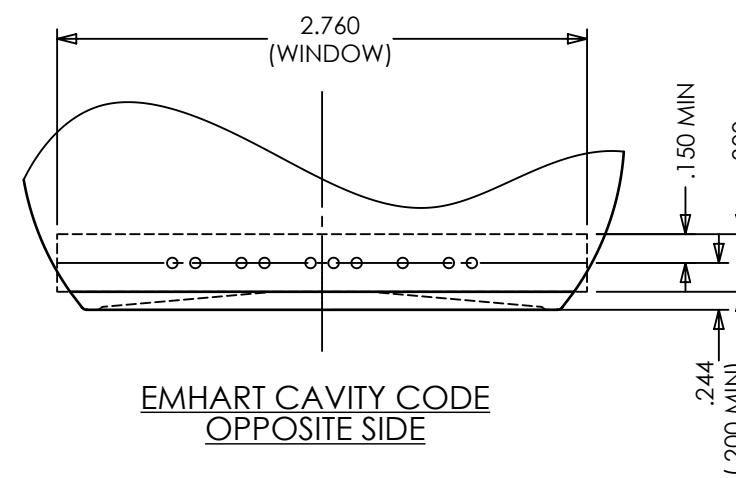

FINISH	OVERFLOW	WEIGHT
70-470 B	16.600 ±.250 FL OZ	8.000 OZ
70-2030	16.300 ±.250 FL OZ	7.830 OZ
70-2035	16.600 ±.250 FL OZ	8.000 OZ

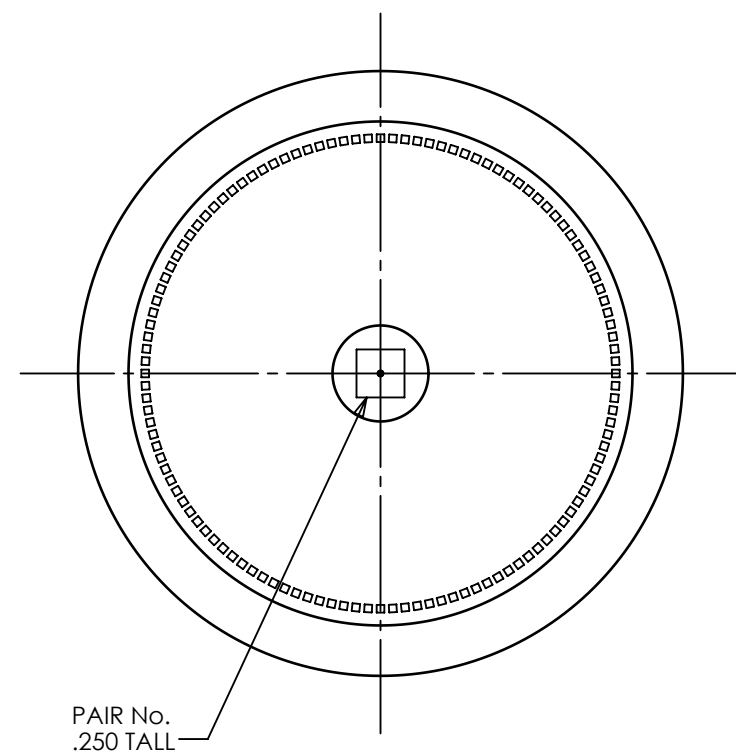
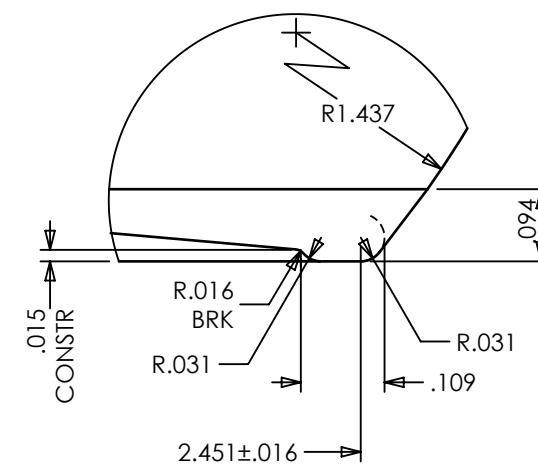

NOTES:  
OVERALL HEIGHT: 5.078" (128.98mm)  
LARGEST DIAMETER: 3.150" (80.01mm)  
THEORETICAL TIP ANGLE > 28° 35'  
THEORETICAL C.O.G: 2.252" UP FROM BASE OF BOTTLE



REV	DESCRIPTION	DATE	APPROVED	PROJECT No:	PB	DWG No:	
13	UPDATED 70-2035 FINISH TO 70-2035 A & ADJUSTED HEIGHTS	4/17/17	S.THOMAS	20087		B-76500	
12	CHANGED DRAWING SIZE TO "B" & ADDED 70-2035 FINISH	3/24/17	S.THOMAS				
11	ADDED STACKER DETAIL	3/10/15	SODE				
10	UPDATED FINISH DESIGNATION, WAS 70-470 IT	1/9/15	SODE				
9	UPDATED TO ANCHOR GLASS STANDARDS	3/6/08	DT				
8	ADD DOT CODING TO ONE SIDE OPPOSITE HEEL LETTERING	9/29/98	DT				
7	CORRECT DIAMETER TO 3.150	7/2/90	DAS				
6	UPDATED DRAWING	1/11/90	DAS				
REVISIONS				REFERENCES:	8722-X; B-97476 (2035 FINISH)		

DESIGN/ENGINEERING	DESCRIPTION:
SIZES & SPECIFICATIONS SHOWN ARE IDEAL ACTUAL SAMPLES WILL DETERMINE SIZES	GENERAL SALE
SCALE: 1:1 SHAPE CODE: 10	16 OZ JAR
OVERFLOW: SEE CHART	ITEM No.: 21706
NOMINAL CAPACITY:	DATE: 9/14/79
WEIGHT: SEE CHART	DRN BY: D. Strohm
	DWG No: B-76500